

**LITHIUM BATTERIES**



**ER17450  
3.6V 3000mAh**

**lithium-thionyl chloride batteries**

**Electrical characteristics**

(Stored for one year or less)

◉ Nominal Capacity ( 3 mA to 2.0V, at 25°C)	3000mAh
◉ Nominal voltage	3.6V
◉ Max continuous discharge current	100mA
◉ Max. Pulse current Current value is obtaining 2.0V cell voltage when pulse is applied for 15 seconds at 50% discharge depth at 25°C	200mA
◉ Storage temperature	20°C ~ 30°C
◉ Operating temperature	-55°C ~ 85°C
◉ Weight(approx)	25g

**WARNING:**

Fire, explosion and severe burn hazard. Do not recharge, crush, disassemble, heat above 100°C, incinerate or expose contents to water.

**Key features**

- High and stable operating voltage
- Low self-discharge rate  
Less than 1% after 1 year of storage at 20°C
- Stainless steel container
- Hermetic glass-to-metal sealing
- Non-flammable electrolyte
- Compliant with IEC 86-4 safety standard
- Non-restricted for transport

 UL Component Recognition  
File Number MH 45782

**Main applications**

- TPMS
- Alarms and security system
- Memory back-up
- Tracking system
- Automotive electronics
- Professional electronics
- Computer real-time clocks

.....

**LITHIUM BATTERIES**

Typical discharge at 25°C

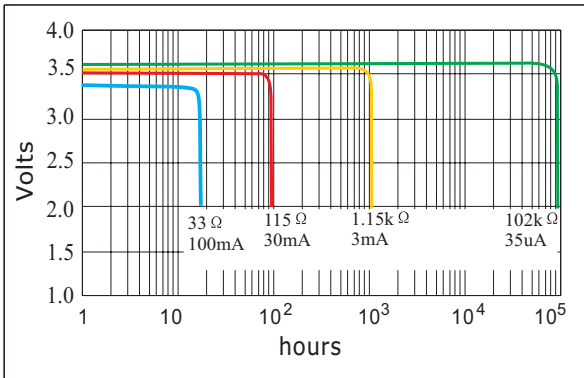

Voltage plateau versus Current and Temperature

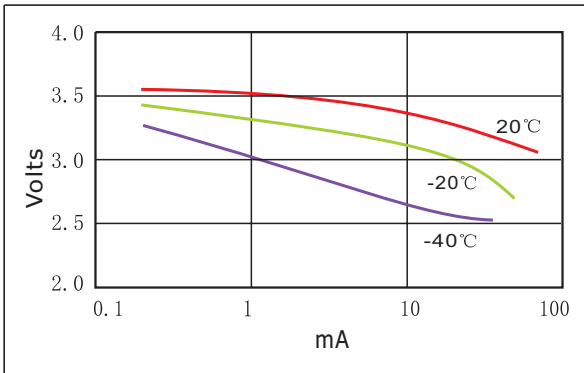

Capacity versus Current and Temperature

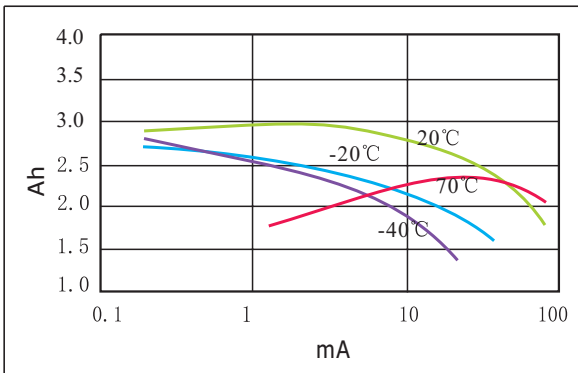

**ER17450**

lithium-thionyl chloride batteries

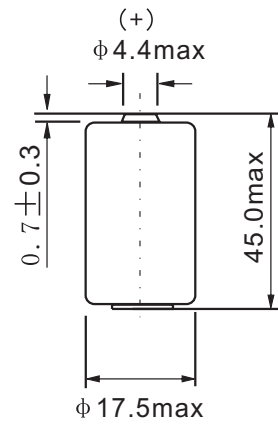

Unit: mm

Available Terminations	
-/P	Axial Pin
-/T /PT2	Radial Pin
-/PT /TP	Polarized Tab