

Thionyl Chloride Lithium Battery(Li/SOCl<sub>2</sub>) TYPE ER14250

(at 23±2°C)

DISCHARGE CHARACTERISTICS @23±2°C

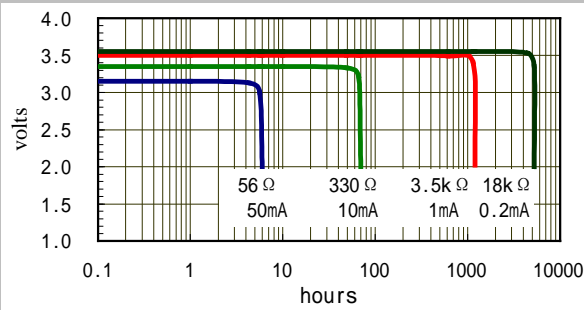

- I Nominal capacity @ 1mA to 2.0V 0.95Ah
- I Nominal voltage 3.6V
- I Maximum current 50mA
- I Maximum pulse current 100mA
- I Weight 10g
- I Volume 4.3cc
- I Operating temperature -55~+85°C

VOLTAGE VS. CURRENT

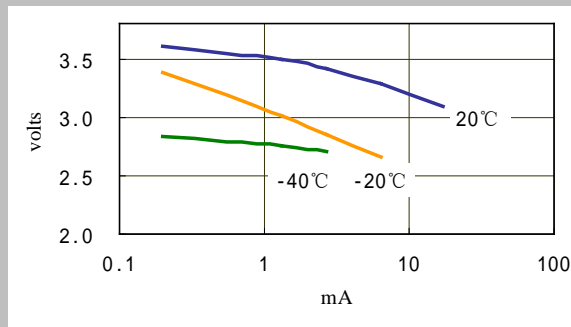

CAPACITY VS. CURRENT

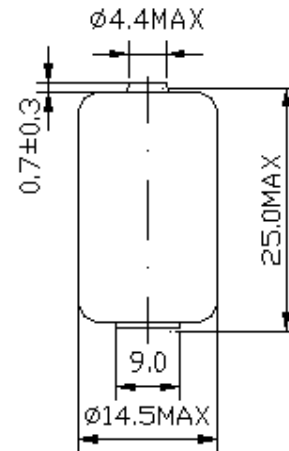
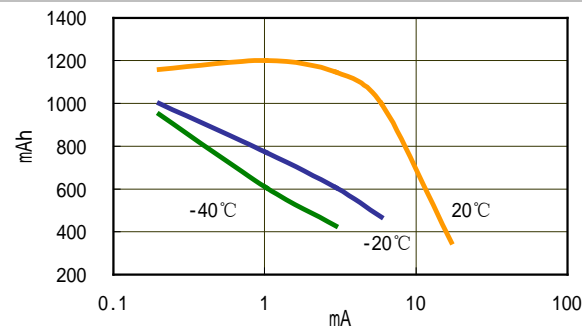

S/: STANDARD  
Dimensions in mm

Available terminations:

- /P AXIAL PINS
- /T /PT2 RADIAL PINS
- /PT/TP POLAREZD TABS

Tel: 86-20-61906348

Fax: 86-20-61906358

E-mail: [info@gmbattery.com](mailto:info@gmbattery.com)