

Thionyl Chloride Lithium Battery(Li/SOCl<sub>2</sub>)TYPE ER17335 (at 23±2°C)

DISCHARGE CHARACTERISTICS @23±2°C

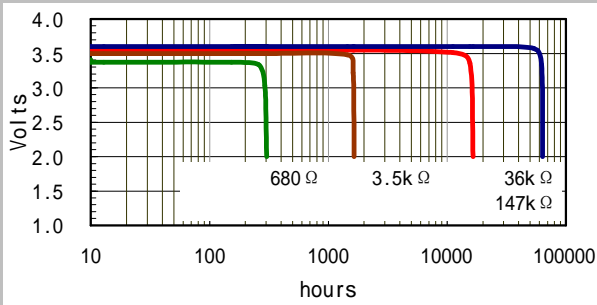

- | Nominal capacity @1mA to2.0V 1.8 Ah
- | Nominal voltage 3.6V
- | Recommend maximum continuous discharge current 50mA
- | Maximum pulse current 100mA
- | Weight 20g
- | Volume 8cc
- | Operating temperature -55~+85°C

VOLTAGE VS. CURRENT

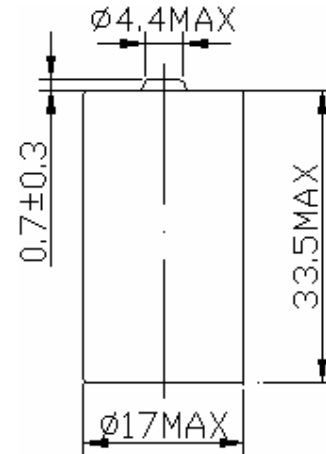
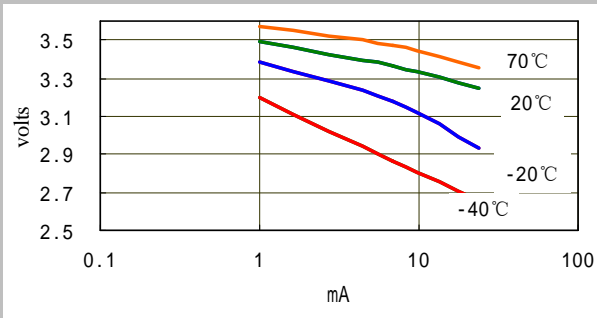

S/: STANDARD  
Dimensions in mm

Available terminations:

- /P AXIAL PINS
- /T /PT2 RADIAL PINS
- /PT/TP POLAREZD TABS

CAPACITY VS. CURRENT

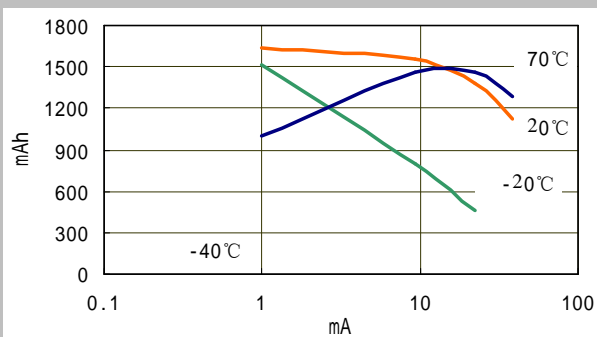

Tel: 86-20-61906348

Fax: 86-20-61906158

Guangzhou Markyn Battery Co., LTD